



PLEASE SPECIFY X, Y & Z DIMENSIONS AT ORDER ENTRY LEVEL.

FOR GALVANISED DAMPERS USE CSNN01768 M/STEEL ANGLE CLEATS
 FOR 430 & 316 ST' STEEL DAMPERS USE CUNN02614 316 ST' STEEL ANGLE CLEATS

FOR FIRE SHIELD "**NON-ACCESS**" FLANGE REFER TO DRAWING AA/F10369
 "**ACCESS SIDE**" FLANGE PLEASE REFER TO DRAWING AA/F9564

FOR TESTED INSTALLATION METHOD REFER TO DRAWINGS SF029 & SF030.

THIS METHOD WOULD BE SUBJECT TO THE SCRUTINY AND APPROVAL FROM THE RELEVANT DISTRICT SURVEYOR / LOCAL AUTHORITY PRIOR TO ORDERING. BLANKING OFF LOCAL TO INTERFACE SHROUD IS REQUIRED, ON SITE, BY OTHERS.

THIS DRAWING IS NOT INTENDED TO ENDORSE THE ARRANGEMENT AS BEING SUITABLE FOR IT'S INTENDED APPLICATION.

THE INFORMATION SHOWN IS SUBJECT TO CHANGE WITHOUT NOTICE DUE TO CONTINUING RESEARCH AND DEVELOPMENT.

Rev	Change	Dates
B	NEW DRAWING FOR FIRE SHIELD AAF10369	12/05/2009
A	NOTES ADDED	17/07/2008
Drawn by S.W.		11/03/2008
Checked by H.T.		04/08/2009
Approved by M.B.		05/08/2009
Customer		
Project		

Description
 G.A. FOR 1.2mm GAUGE ANGLE FLANGE & CLEATS
NON-ACCESS SIDE PTC DAMPERS

Drawing No. AA/F10187
 Revision B

NON-ACCESS SIDE

50x50 ANGLE CLEATS
 C/W 14 x 24mm SLOT,
 WELDED ONTO CENTRE LINE
 OF DAMPER CASING AS SHOWN.

INTERFACE SHROUD

ACCESS SIDE

1.2mm x 78mm + 'Y' mm. ('Y' DIMENSION IS 5mm, MINIMUM, UNLESS OTHERWISE STATED) x 'X' mm ('X' DIMENSION IS 60mm, UNLESS OTHERWISE STATED) UPSTAND ANGLE FLANGE TO BE TACK WELDED TO THE DAMPER OUTER CASING (EVERY 150mm CTR, 50mm MAX FROM ENDS) ON ALL FOUR SIDES.

ANGLE FLANGE TO STOP SHORT, EITHER SIDE OF PTC INTERFACE SHROUD, AS SHOWN. BLANKING OFF LOCAL TO INTERFACE SHROUD IS REQUIRED, ON SITE, BY OTHERS.

CLEATS WELDED FLUSH WITH TOP OF DAMPER CASING UNLESS OTHERWISE STATED 'Z' DIM

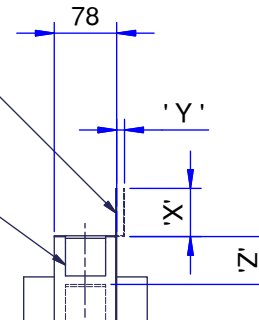

ACTUATOR

ACCESS SIDE

NON-ACCESS SIDE

ALL FOUR CORNERS TO BE FULLY WELDED TO THE DAMPER CASE.