

Notes:

- 1/ In case of reinforced concrete walls and floors, the tabs shall be bent out and tied with wire to the reinforced bars which will be deliberately left protruding into the opening.
- 2/ In absence of reinforced concrete bars, steel fixings to be fitted into slab adjacent to builders ties. (e.g. M8 stud anchors), and the builders ties tied back to steel fixings (or wired minimum 1.5mm Ø steel wire).
- 3/ The gap between the installation frame and builders work shall be back filled with mortar or concrete on both sides of the damper.
- 4/ In no case shall the HEVAC/HVCA frame and damper assembly be held in position merely by the adjacent ductwork, and it should be noted that reinforced concrete structures (especially floors), it will not be sufficient to only back fill between the damper installation frame and the surrounding opening with mortar or fine aggregate concrete mix without provision for tying in the frame to the surrounding reinforced concrete structure.
- 5/ This arrangement is subject to local authority or district surveyor approval.

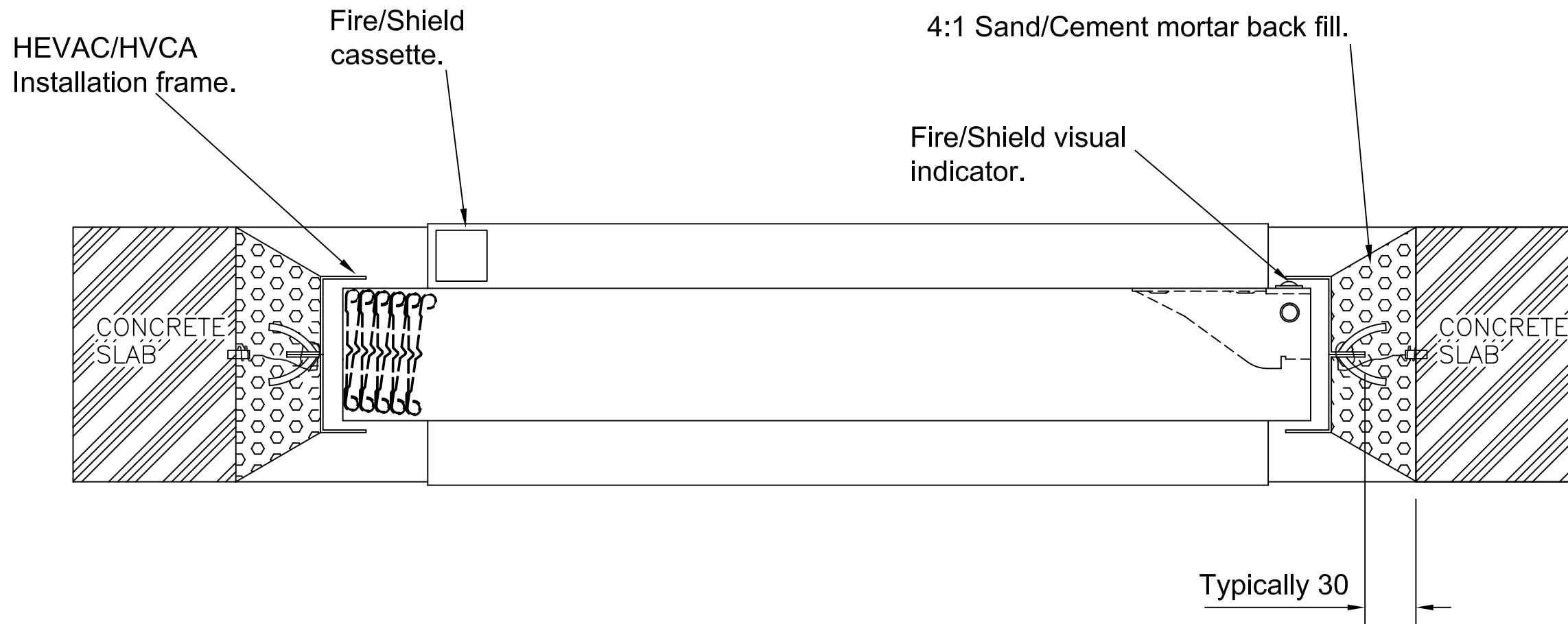

Rev	Date	Description	
A	12/02/01	INFORMATION UPDATED	
Drawn By		Checked By	Approved By
A.M		<i>MB</i>	<i>Rnw</i>

Title. FIRE/SHIELD WITH INSTALLATION FRAME IN CONCRETE SLAB

Date	Drawing Number	Revision
30/01/01	AA/F/7510	A

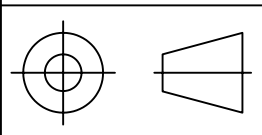

ALL UNITS MM UNLESS STATED	FOR INFORMATION ONLY	Customer	Project
DO NOT SCALE	IF IN DOUBT CONTACT ACTIONAIR		